

If you need to bend the heater 180°, make sure to use a pipe as support of minimum radius 10 mm. This will prevent the heater to be damaged.

For further information, get in contact with your local distributor of Heatlock. Latest information always available at www.heatlock.com.

Part No.	CC	L	Watt
MHI0600350	60	296	350
MHI0800400	80	325	400
MHI1000450	100	365	450
MHI1200500	120	405	500
MHI1400550	140	445	550
MHI1600600	160	485	600
MHI2000700	200	567	700
MHI2400850	240	647	850
MHI2800950	280	727	950

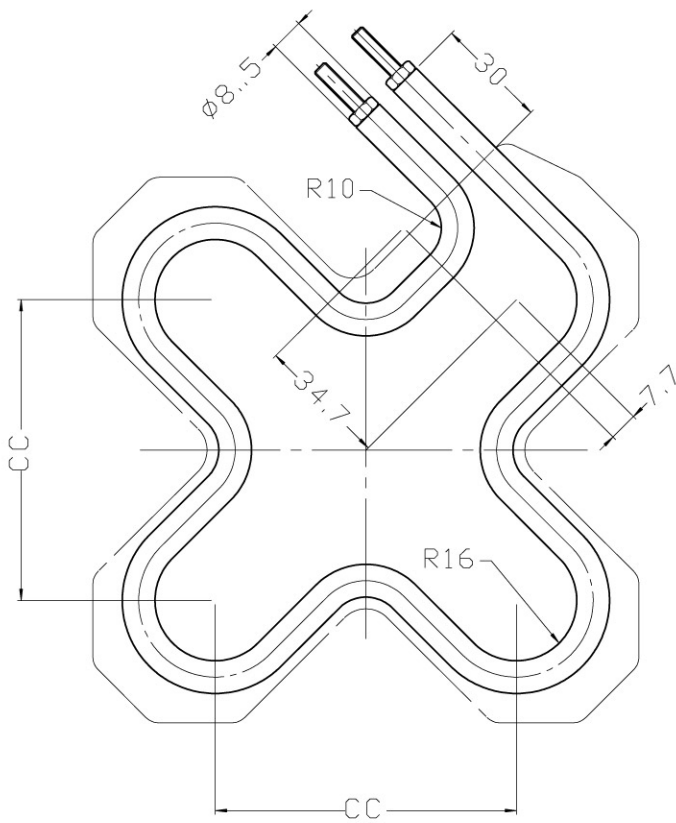

CC ≤ 100MM

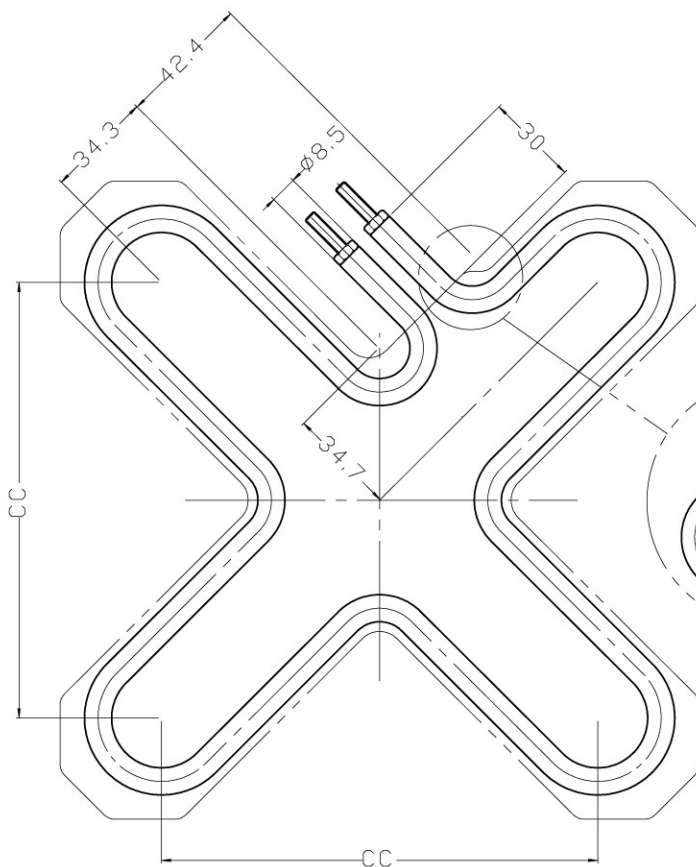

CC ≤ 240MM

Part No.	CC	L	Watt
MHX0600550	60	455	550
MHX0800700	80	567	700
MHX1000900	100	681	900
MHX1201000	120	772	1000
MHX1401200	140	886	1200
MHX1601350	160	1005	1350
MHX2001650	200	1228	1650

If you need to bend the heater 180°, make sure to use a pipe as support of minimum radius 10 mm. This will prevent the heater to be damaged. For further information, get in contact with your local distributor of Heatlock. Latest information always available at www.heatlock.com.

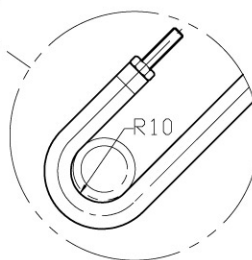

Additional bending of existing one

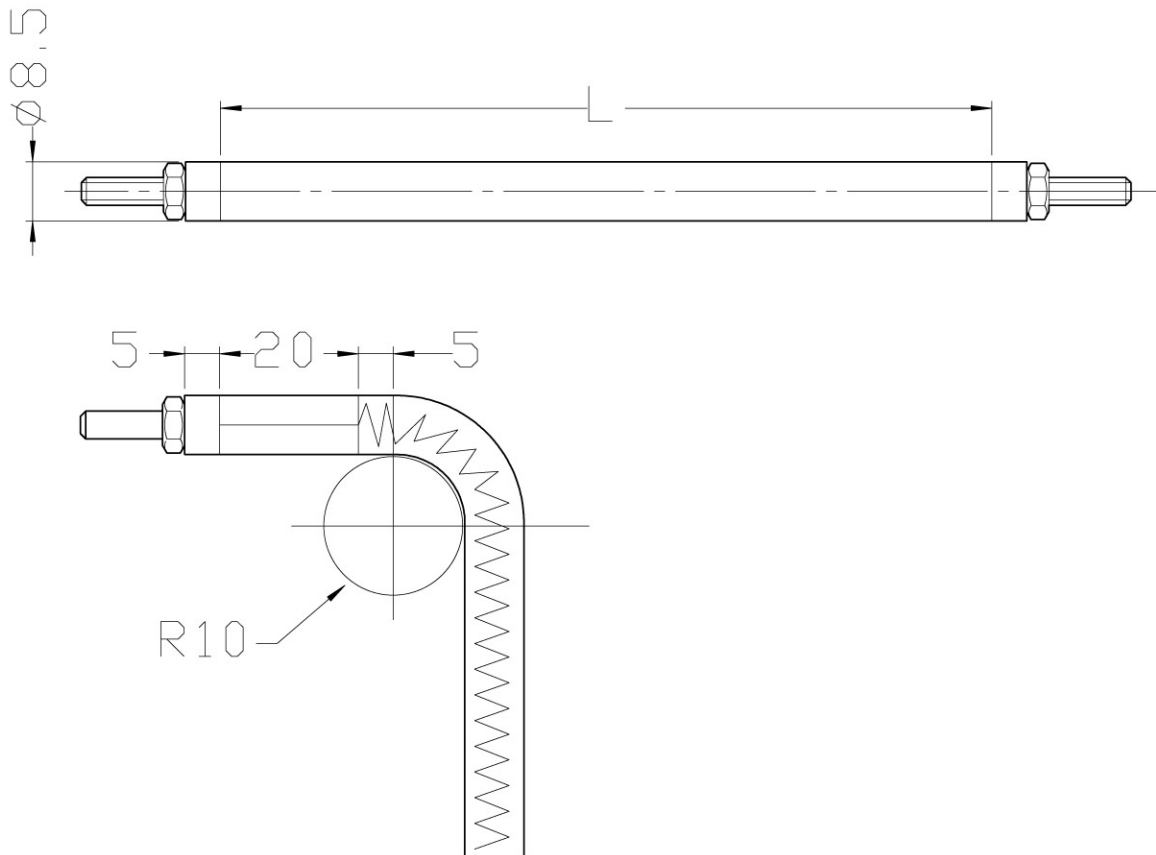

Bending Instruction: The tube cladding must not be damaged by impact from hammers or damaged by scars. Once a tubular heater has been bent, it must not be bent back on the same spot.

Part No.	L	Watt
RH8502960350	296	350
RH8503250400	325	400
RH8503650450	365	450
RH8504050500	405	500
RH8504450550	445	550
RH8504550550	455	550
RH8504850600	485	600
RH8505670700	567	700
RH8506470850	647	850
RH8506810900	681	900
RH8507270950	727	950
RH8507721000	772	1000
RH8508861200	886	1200
RH8510051300	1005	1300
RH8512281650	1228	1650